

GEMEINDE ESCHENBACH

KT. LUZERN

ERSCHLIESSUNG GRUNDSTÜCK NR. 181 SOMMERAU

SITUATION 1:500

KANALISATION
WERKLEITUNG

PROJEKTPLAN

ERSCHLIESSUNGSPLAN GRUNDSTÜCK NO. 181
"SCHLETTLIWEID" GB. ESCHENBACH

FIRMA MARTI AG. LUZERN

MST 1:500

SITUATION 1:500

GR 17178

DAT 12.11.81

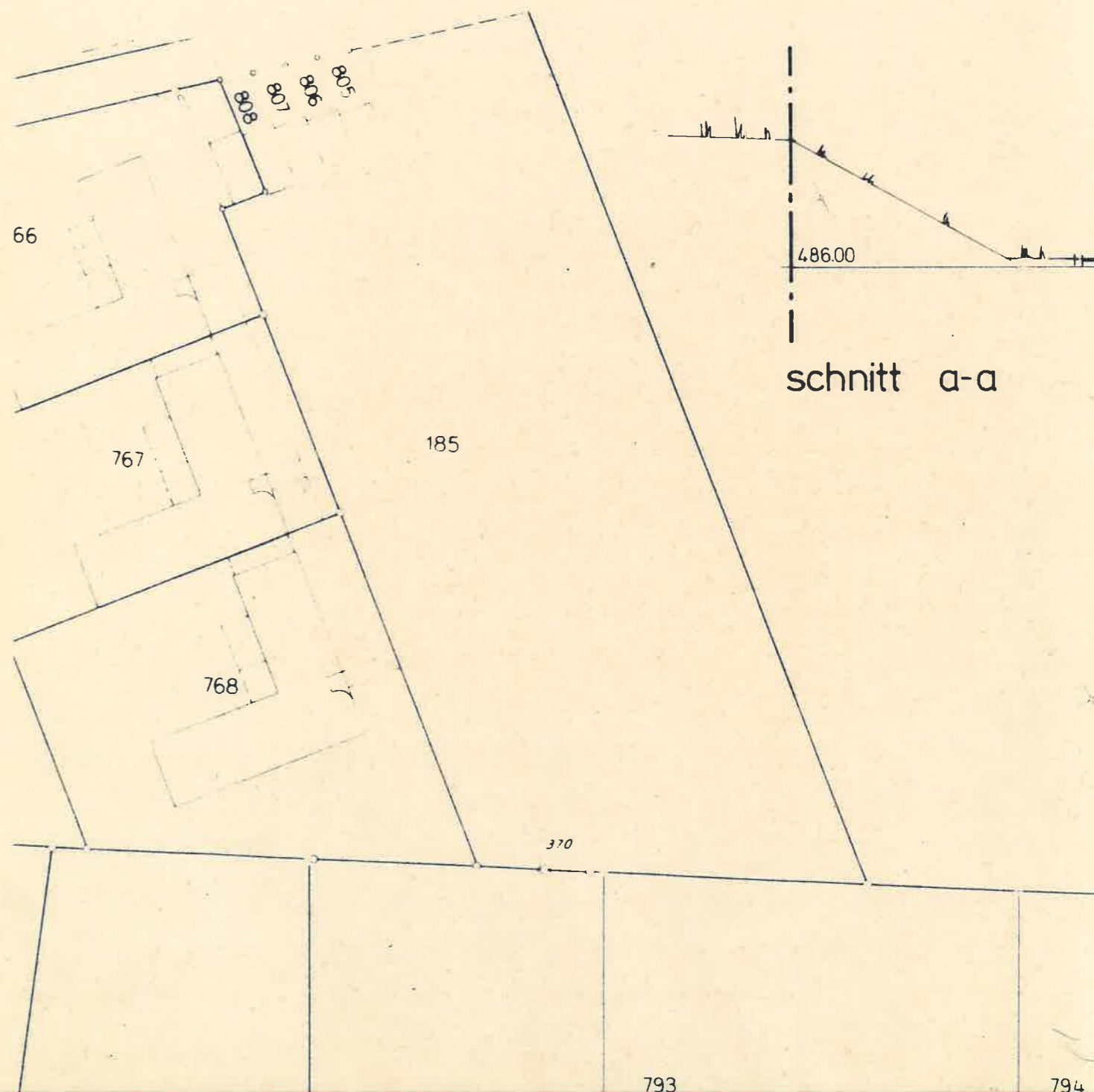

Bauherr : FIRMA MARTI AG, LUZERN

Dat. : 24. 3. 1982

Gez. : FB

Erg. : 5. 4. 1982

Plan Gr. : 38 / 99

PLAN NR. 8159 - 1A

INGENIEUR-PLANUNGS AG

ROMAN STUDER dipl. Ing. ETH · SIA

Telefon 041 - 89 24 88 / 99 17 50

INGENIEURBÜRO

für Hoch - Tief - und
Stahlbau

«POST»

6274 ESCHENBACH

793

794

KANALISATION / TRENNSYSTEM

METEORWASSER : M

KS I. M 90/110(60/100) KS V. M 90/110

D ≅ 482.34 D ≅ 487.28
 A = 479.92 (T≅ 2.42) A = 487.58 (T=0.70)
 Er= 479.97 E = 487.63

KS II. M 90/110 KS VI. M 90/110

D ≅ 484.40 D ≅ 488.40
 A = 482.50 (T=1.90) A = 487.70 (T=0.70)
 E = 482.59r.482.70v.ob. E = 487.75

KS III. M 90/110 KS VII. M 90/110

D ≅ 485.07 D ≅ 488.23
 A = 483.57 (T=1.50) A = 487.38 (T=0.85)
 E = 483.62r.483.77v.ob. E = 487.43

KS IV. M 90/110 KS VIII. M 60

D ≅ 485.75 D ≅ 483.50
 A = 484.50 (T=1.25) A ≅ 482.80 (T=0.70)
 E = 484.70 E ≅ 482.85

FÄKALWASSER : F

KS I. F 90/110 KS V. F 90/110

D ≅ 482.11 D ≅ 487.28
 A = 479.43 (T≅ 2.68) A = 487.08 (T=1.20)
 Er= 479.48 E = 487.13

KS II. F 90/110 KS VI. F 90/110

D ≅ 484.20 D ≅ 488.40
 A = 482.00 (T=2.20) A = 487.20 (T=1.20)
 E = 482.09r.482.20v.ob. E = 487.25

KS III. F 90/110 KS VII. F 90/110

D ≅ 484.47 D ≅ 488.23
 A = 483.07 (T=1.40) A = 486.88 (T=1.35)
 E = 483.12r.483.27v.ob. E = 486.93

KS IV. F 90/110

D ≅ 485.20 D = DECKELHÖHE
 A = 484.00 (T=1.20) A = AUSLAUF
 E = 484.20 E = EINLAUF
 SA = SOHLENABSTURZ

LEITUNGEN : CANAL - ETERNITROHR / HPVC - ROHR (IKP GEPRÜFT) =====

WERKLEITUNGEN :

TRINK - LÖSCHWASSER

ELEKTRISCH

TELEFON

TV

STR. - BELEUCHTUNG (EVENT.)

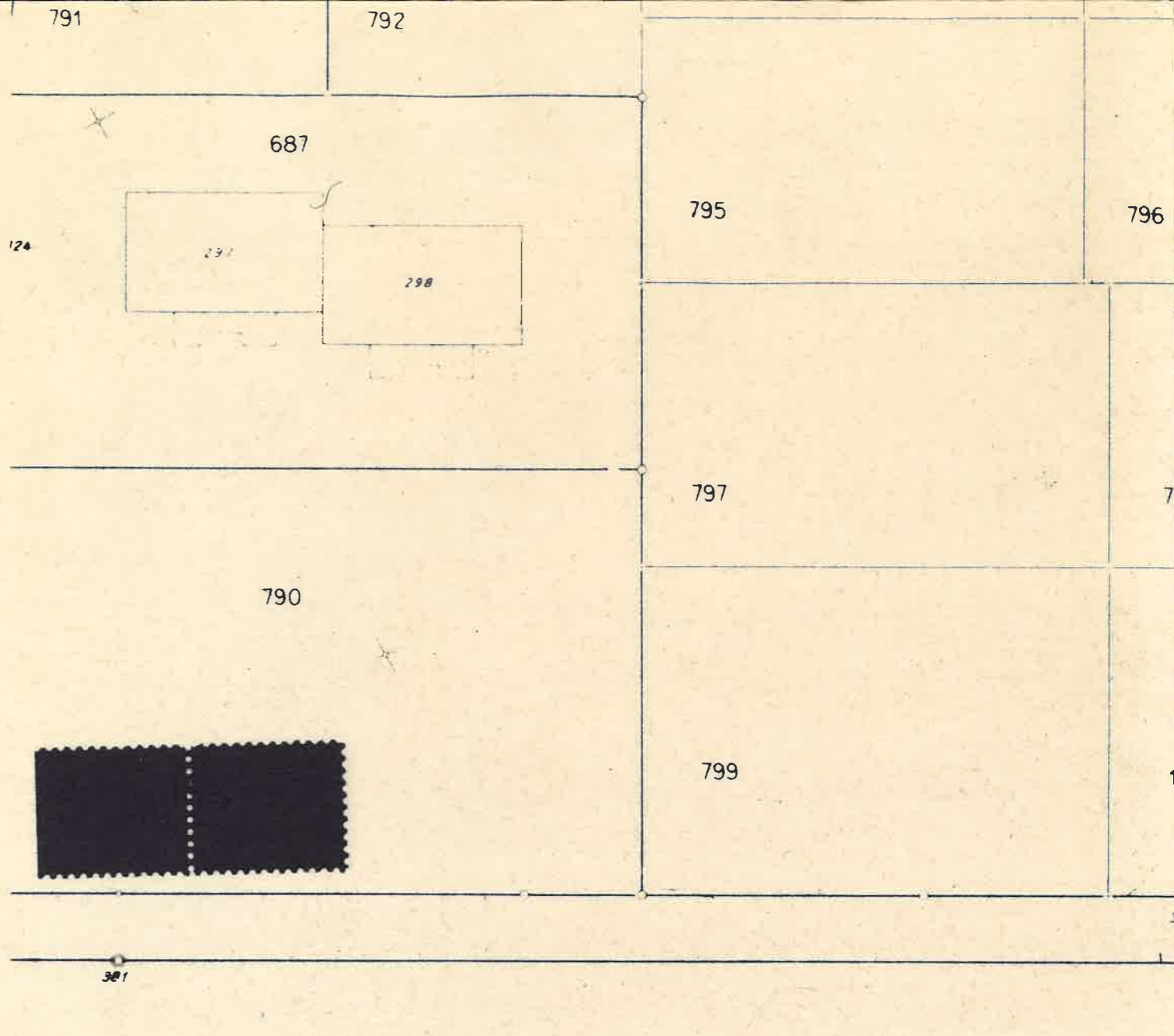

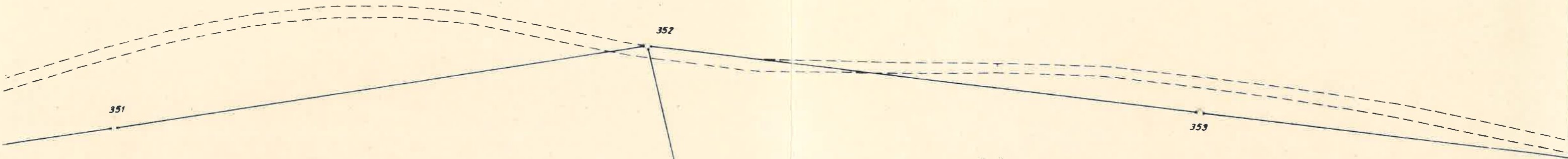

Schlettli

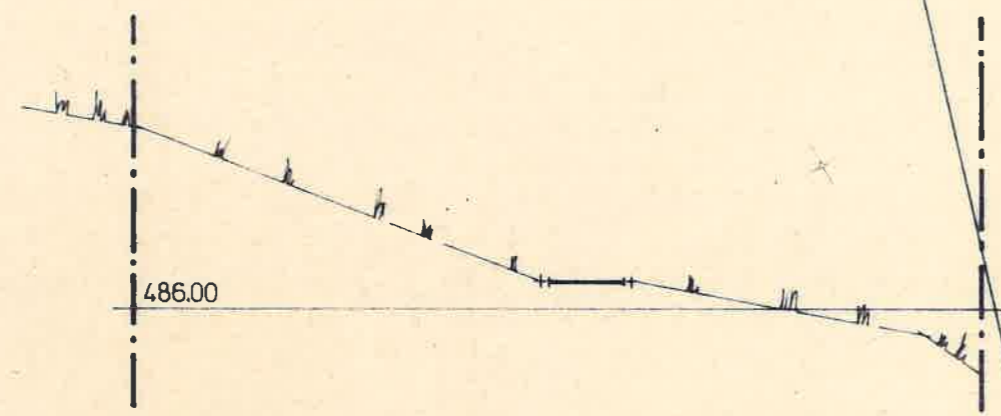

schnitt b-b

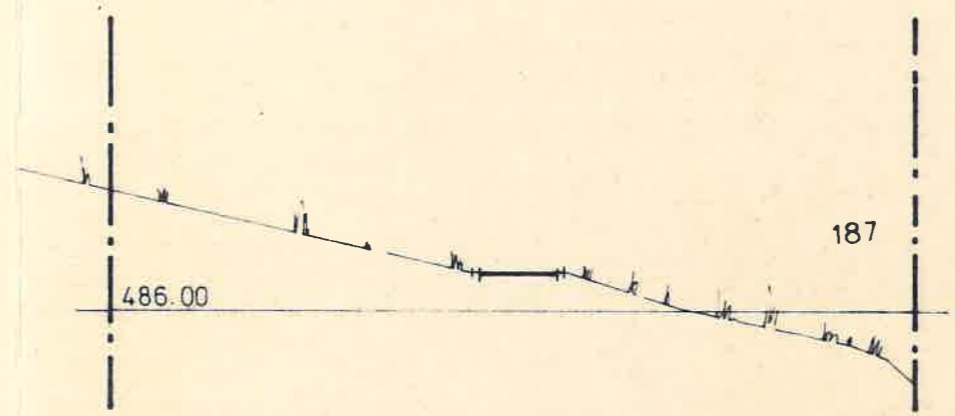

schnitt c-c

186

187

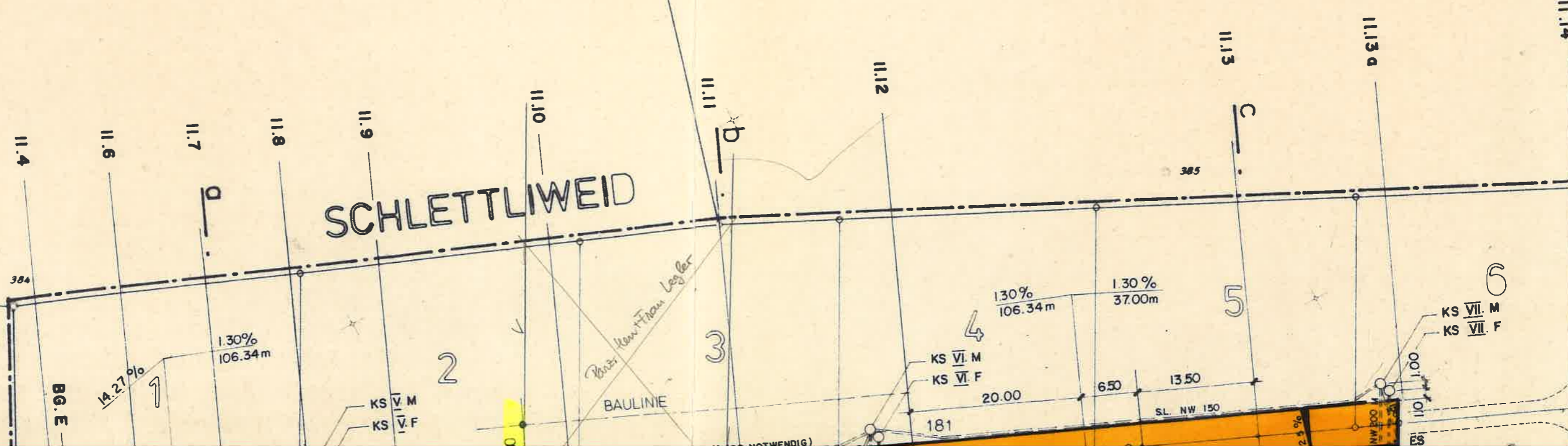

SCHLETTLIWEID

Bau-Plan-Form-Log-Bo

BAULINE

B.G. E

14.27%

1.30%
106.34m

KS V. M
KS V. F

1.30%
106.34m

1.30%
37.00m

KS VI. M
KS VI. F

20.00

6.50

13.50
SL. NW 150

KS VII. M
KS VII. F

001
011
181

NOTWENDIG

2.5%

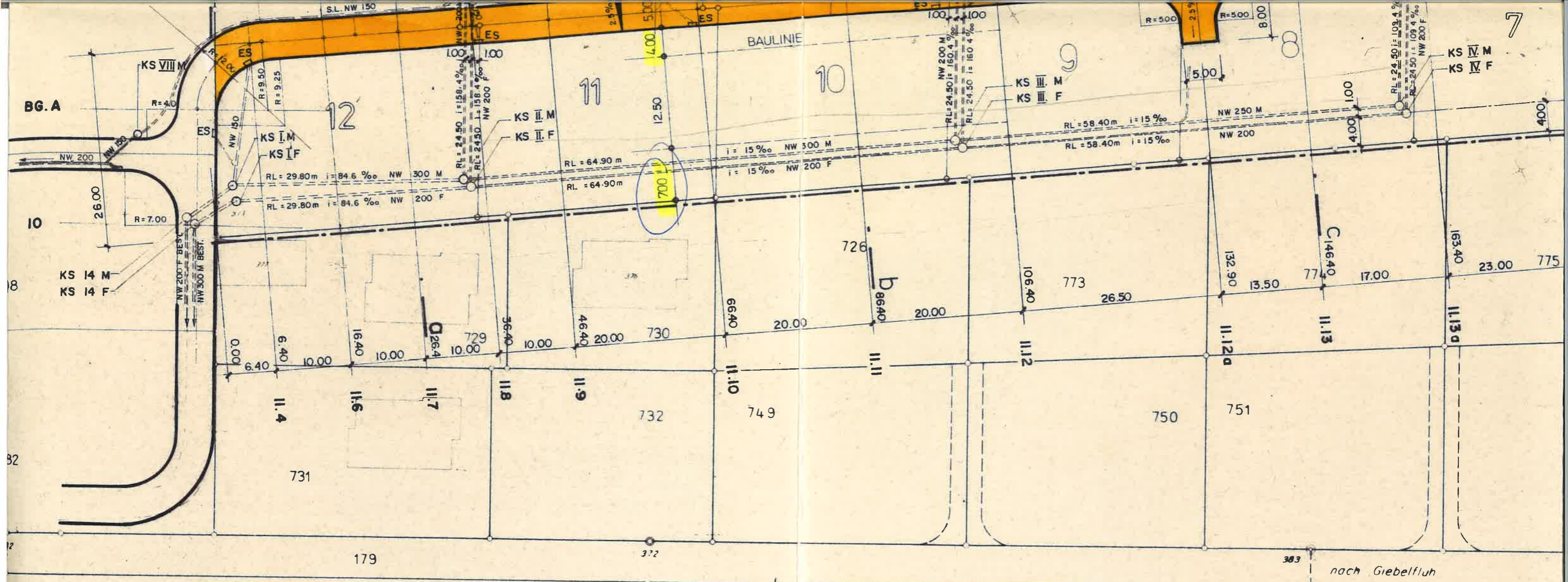

Gemeinde Eschenbach

1:500

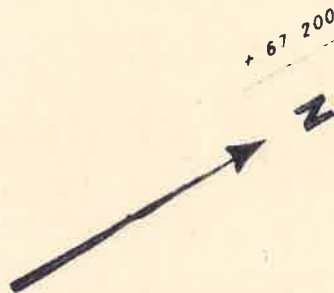
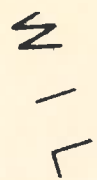

EB 6

+ 67 200

+ 21 550

+ 67 250

354

+ 67 300

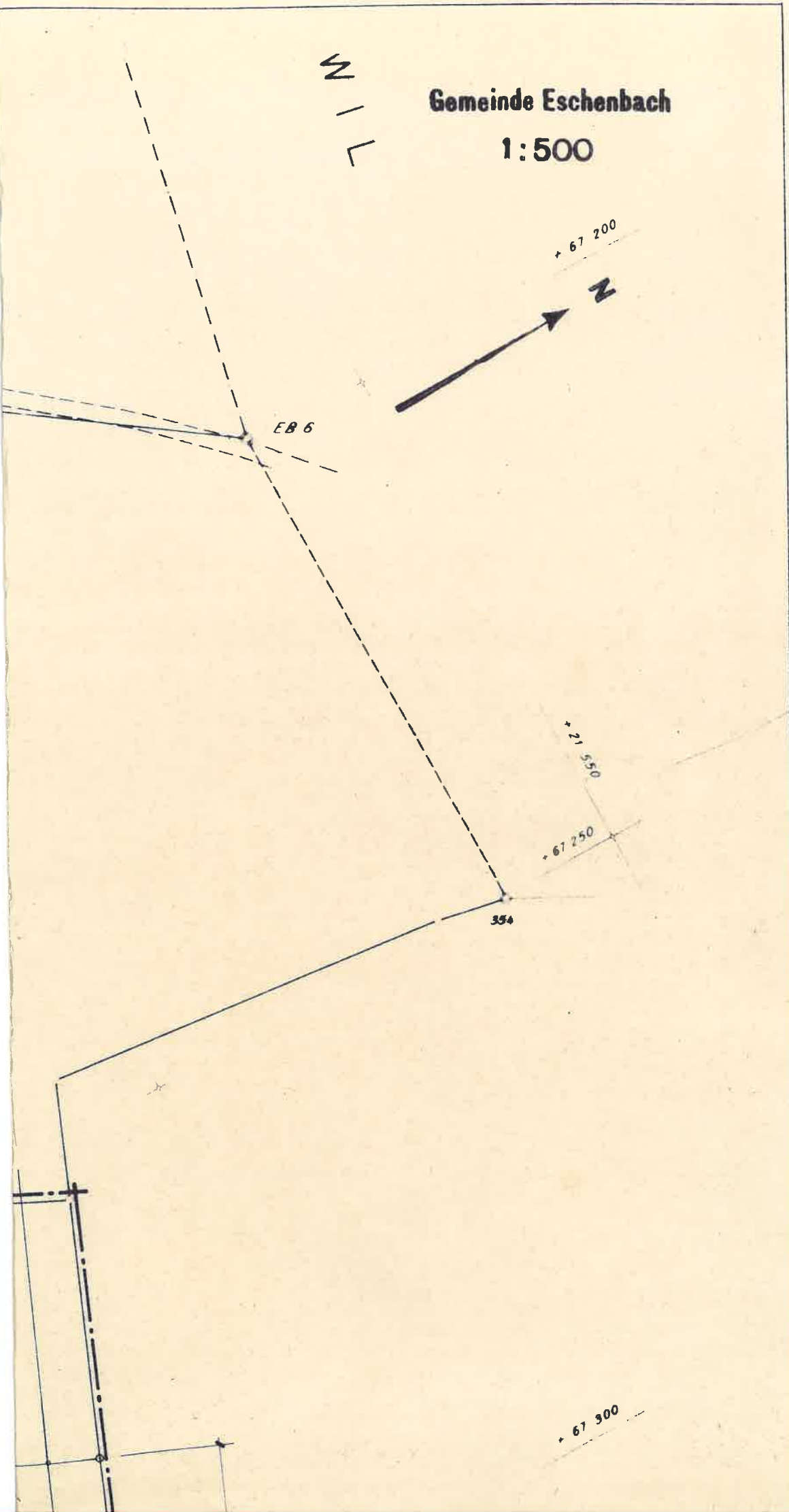

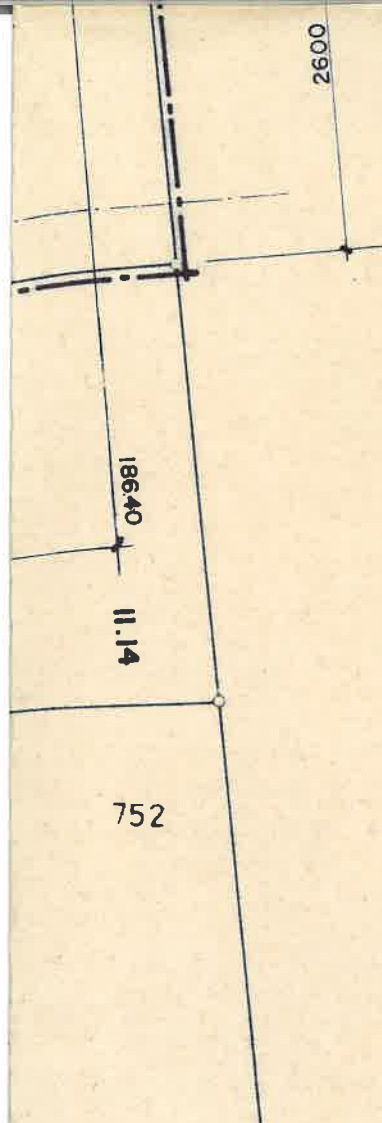

P
l
a
n
8

* 21 500

Umkartierung 1974

Grundbuchgeometer

Alex Oregger

INGENIEURE WSB
Der Nachführungsgeometer
G. Wyssling 6020 Emmenbrücke
Rüeggisingerstr.29 Tel.041 556622

9. Nov. 1981

1:500